

## Handling System for Hood type Pre-wash Table with 600x500 Bowl Left to Right, 1200mm

ITEM # \_\_\_\_\_

MODEL # \_\_\_\_\_

NAME # \_\_\_\_\_

SIS # \_\_\_\_\_

AIA # \_\_\_\_\_

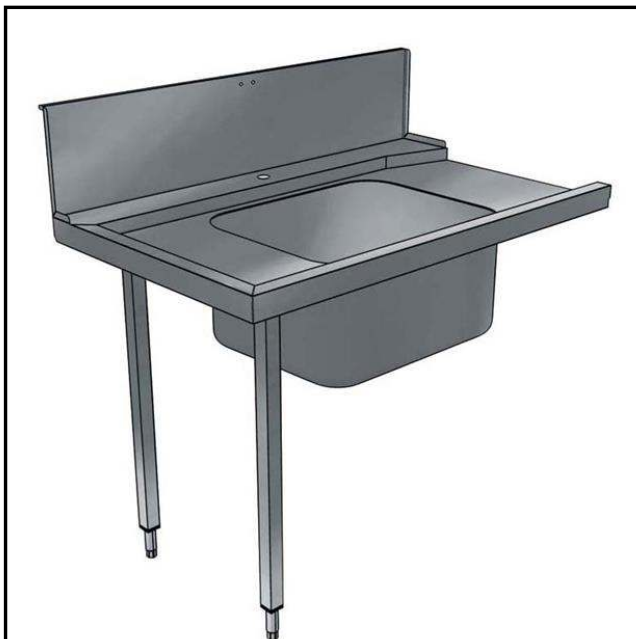

865315 (BHHPT6B12L)

Prewash table with  
600x500mm bowl for hood  
type, l>r, 1200mm

### Short Form Specification

#### Item No. \_\_\_\_\_

For hood type dishwashers. Constructed in 304 AISI stainless steel. Backsplash mm300h. N. 2 square 40x40mm tubular legs on height-adjustable feet. Bowl size mm600x500x300h with overflow pipe, drain hole and plastic syphon. Basket direction: from left to r

### Main Features

- Supplied knocked-down and easy to assemble.
- Plain undershelves and pre-rinse units available as optional accessories.

### Construction

- Stainless steel feet 50 mm adjustable in height to ensure that tables drain back into the dishwasher.
- 700x500x300mm bowl available upon request.
- Included splashback to prevent water leakage.
- Deep anti-drip profiles completely folded with lower edge for safe and easy cleaning.
- All surfaces smooth with polished finish.
- 40x40 mm square tubular legs in AISI 304 stainless steel.
- 304 AISI stainless steel construction throughout.
- To be secured to the dishwasher and fitted with one pair of legs at the other end.

### Sustainability



- Designed for 500x500 mm dishwashing racks (it is necessary to connect a rail to the table to avoid baskets from falling).

### Optional Accessories

- Undershelf for dishwasher table, 1200mm PNC 865352 ☐
- BASKET GUIDE FOR DW TABLES W/BOWL 600MM PNC 865370 ☐
- FLOOR FASTENING KIT FOR 2 SQUARE LEGS PNC 865386 ☐
- Single plastic drain syphon 2" PNC 895313 ☐

APPROVAL: \_\_\_\_\_



**Electrolux**  
PROFESSIONAL

## Handling System for Hood type Pre-wash Table with 600x500 Bowl Left to Right, 1200mm

Front

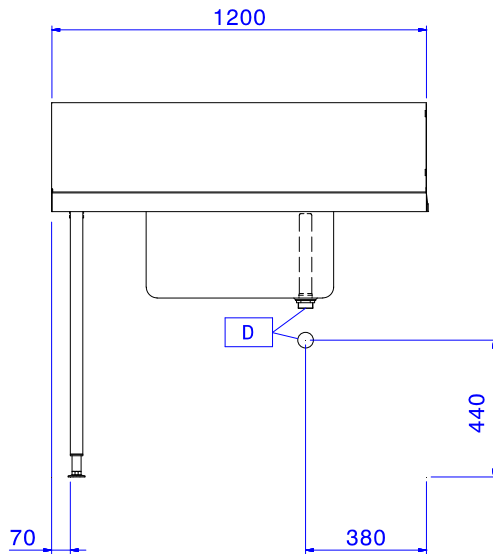

Side

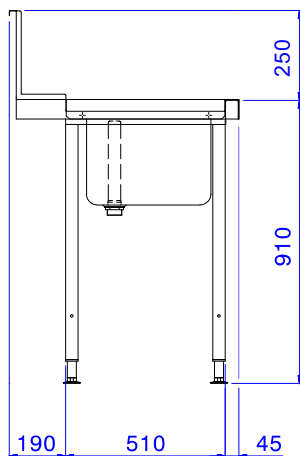

Top

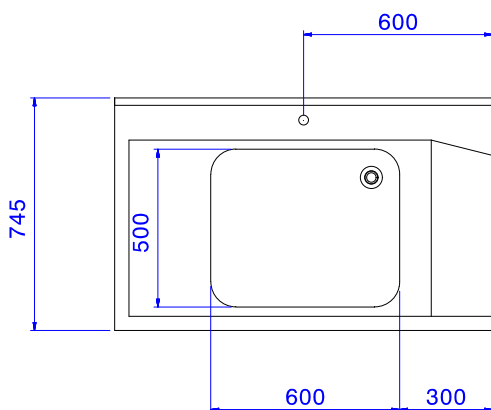

### Key Information:

|                                |              |
|--------------------------------|--------------|
| External dimensions, Width:    |              |
| 865315 (BHHPT6B12L)            | 1200 mm      |
| External dimensions, Depth:    | 745 mm       |
| External dimensions, Height:   | 1170 mm      |
| Net weight:                    | 8 kg         |
| Splashback Dimensions, Height: | 300 mm       |
| Basin dimensions:              | 600x500x300h |

Handling System for Hood type  
Pre-wash Table with 600x500 Bowl Left to Right, 1200mm

The company reserves the right to make modifications to the products without prior notice. All information correct at time of printing.

2025.04.18